

## FULLY AUTOMATIC TRAY FORMER

### MODEL TF-300T



**IPak's Model TF-300T** fully automatic tray former is designed and built to withstand the rigors of continuous, heavy-duty, industrial applications. The TF-300T forms triangulated corner post trays. Whether for agricultural, food processing, distribution, retail display or any other application, the TF-300T can form standard triangulated corner post trays or specialty trays with top flaps, stacking ledges, corner caps, display openings, etc. It will continuously operate at speeds of up to 30 trays per minute and is capable of forming a wide range of tray sizes. Size changes are quick and easy, and depending on tray style can be performed in about 20 minutes. Like all IPak machinery, the TF-300T is known for reliability and dependability and is backed by IPak's friendly and knowledgeable service team.

IPak Machinery - it simply works better

**IPak Machinery Ltd.**  
Supplying Effective Packaging Solutions

## STANDARD FEATURES

- All mechanical drive train
- Easy load hopper
- Venturi type vacuum pick system
- Offset dual vacuum cam design
- Corrosion resistant construction
- Remote Demand Controlled
- Nordson hot melt adhesive system
- All controls 24 Volts DC
- Allen-Bradley PLC
- Fully interlocked safety guarding

## OPTIONAL FEATURES

- Large capacity glue system
- Quick size change features
- Left or right hand controls
- Custom voltages
- Modifications for under or oversize cases
- High speeds - over 30 trays per minute
- Choice of hot melt glue systems
- Machine monitoring system with beacon
- Motorized outfeed conveyor
- Choice of PLC

## MACHINE SPECIFICATIONS

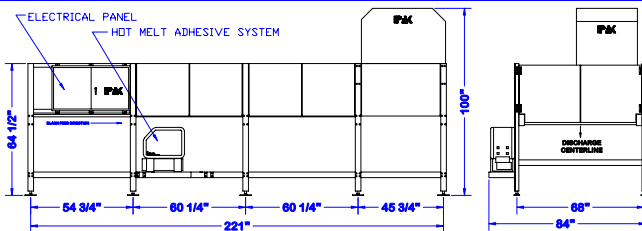

- Machine weight: Approx. 4200 lbs.
- Machine length (typical): 18'6"
- Air: 1.0 cubic feet per cycle at 90 p.s.i.
- Electrical: 230/460 Volts AC, 3 phase, 60 Hz
- Speeds up to 30 trays per minute
- PLC operated sequence and timing control
- External digital glue pattern timing controls
- NEMA 12 control panel
- Nordson hot melt adhesive system
- Lock-out / tag-out compliant

## METHOD OF OPERATION

The TF-300T hopper is loaded with die cut blanks. Vacuum cups pull the blanks from the hopper onto the lug and chain drive. The blank is advanced, adhesive is applied, and the corner posts are pre-formed. The blank is stopped and the corner posts are compressed while the blank is stationary, ensuring accurate alignment of all corners. The blank is then advanced past secondary glue application and then into the compression section where it is impacted by a forming mandrel and the glue bonds are compressed. Any final processes, such as display flap folding, are completed and the finished tray is discharged upright onto a conveyor ready for filling.

## SOME EXAMPLES OF TRAYS FORMED ON THE TF-300T

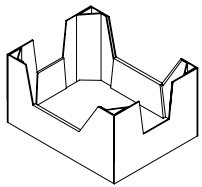

DISPLAY TRAY WITH TRIANGULAR CORNERS

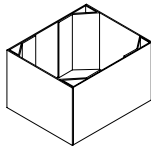

TRIANGULATED CORNER TRAY

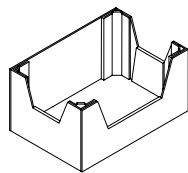

DISPLAY TRAY WITH TRIANGULAR CORNERS

## THE IPAK PRODUCT LINE INCLUDES:

- |                 |                          |
|-----------------|--------------------------|
| Tray Formers    | Flange Sealers           |
| Case Sealers    | Stackers and De-Stackers |
| Sleeve Wrappers | Custom Applications      |

## DISTRIBUTED BY:

## IPak Machinery Ltd.

160-6165 Highway #17, Delta, BC, Canada V4K 5B8 Phone (604) 940-8073 Fax (604) 940-8074  
 Email: sales@ipakmachinery.com www.ipakmachinery.com